



Serie

Silver - 60

Especificaciones Técnicas

Carpintería Corredera

Cerco y Hoja Perimetral

Sección de Marco 60 mm.

Sección de Hoja 24 x 58 mm.

Galce de vidrio Vidrios hasta 15 mm. (18 mm. de hueco)

Peso Máximo por Hoja : 50 Kg.

Posibilidad de colocación de Herraje Multipunto Corredera

Clasificación obtenida

Permeabilidad al aire*	CLASE 3
Estanqueidad al agua*	CLASE 6A
Resistencia al viento*	CLASE C1
Transmitancia térmica**	3,8 W(m ² K)
Aislamiento acústico***	29 (-1;-2)dB

* Ventana de 2 hojas de 1230 x 1480 mm.

** Ventana de 2 hojas de 1480 x 2180 mm. con cajón de persiana ; Vidrio 4-10-4

*** Ventana de 2 hojas de 1230 x 1480 mm ; Vidrio 4-6-4

Posibilidades de Apertura

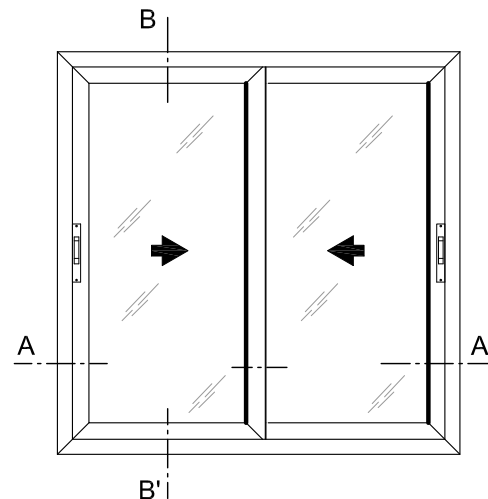
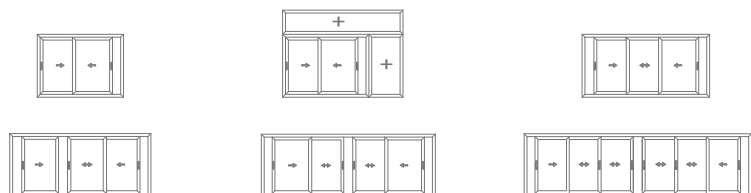

VENTANA DE 2 HOJAS CORREDERAS

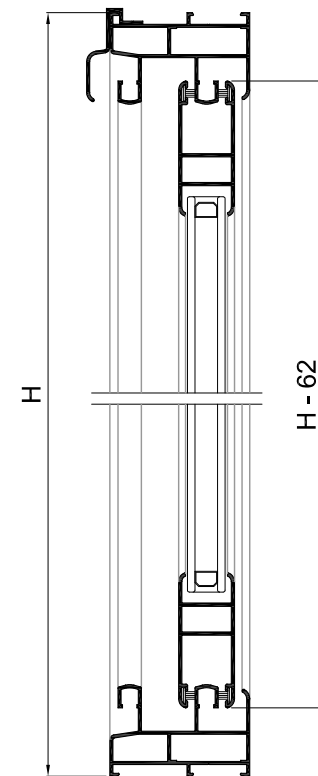

Sección B-B'

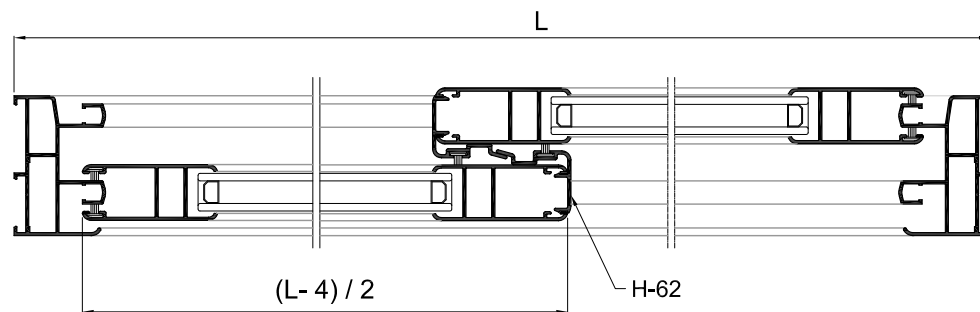

Sección A-A'

Perfiles

Silver - 60

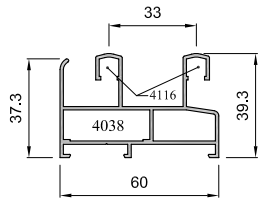

8520

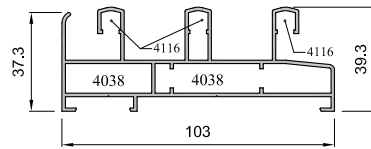

8519

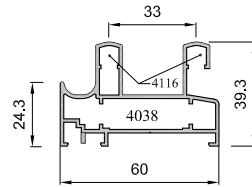

8547

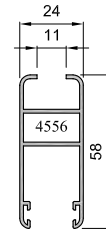

8537

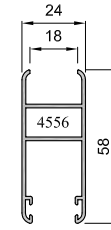

8560

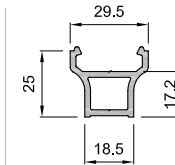

783
6695

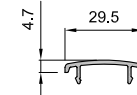

784
6696

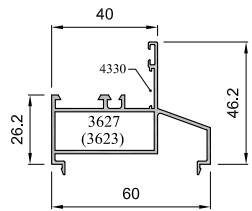

497
2252

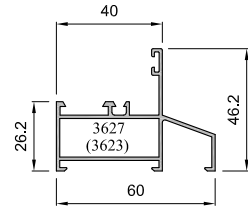

496
2248

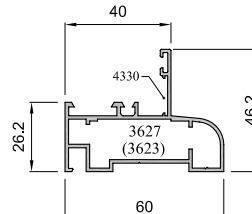

8593

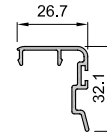

8538

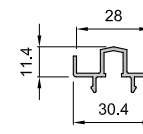

8569

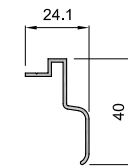

8521

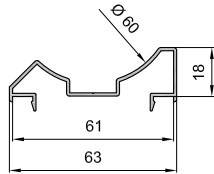

507
6611

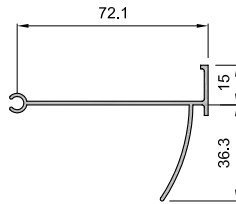

610
6115

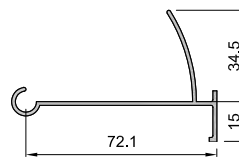

611
6116

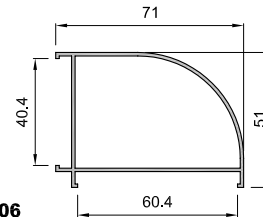

506
6612

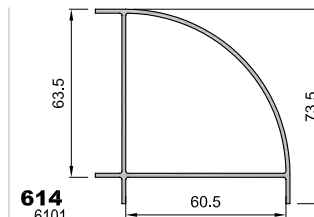

614
6101

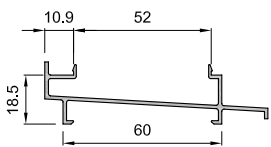

462
2254

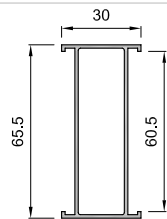

511
6622

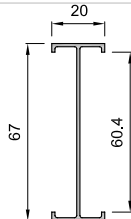

613
6110

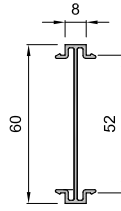

466
2241

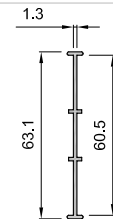

220
1029

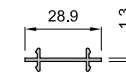

8589

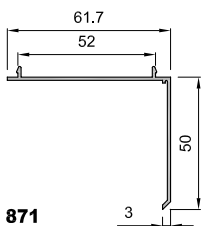

871
3061

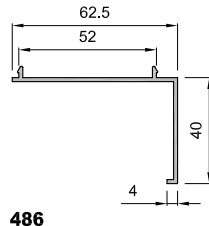

486
2060

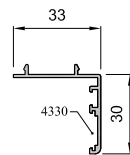

327
1434

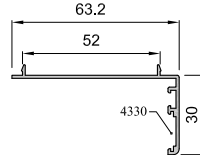

461
2233

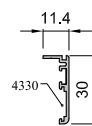

281
1140

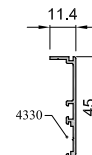

8629

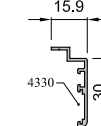

8832

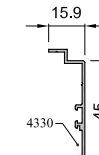

8630



Accesorios

Silver - 60

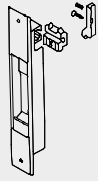

4551

Cierre Embutido peque.
s/condena

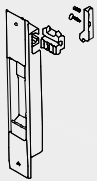

4558

Cierre embutido
peque. c/condena

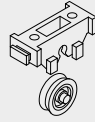

4126

Rueda sencilla nylon

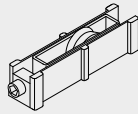

4102

Rueda regulable (Zamak)



4107

Embellecedor acop.
hoja central

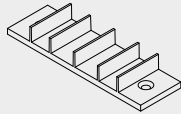

4553

Cortavientos
Silver-60/70

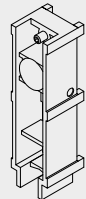

4182
Tope Guiador
(Jgo. 4)

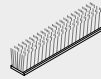

3204

Felpudo Fean Seal
7 x 6.5 mm.

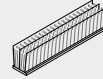

4178

Felpudo Tri-Fin
7 x 6.5 mm.

CIERRE MULTIPUNTO E : 7.5 mm

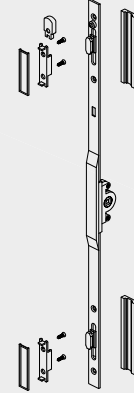

4187

Cierre multipunto
H= 668 - 1068

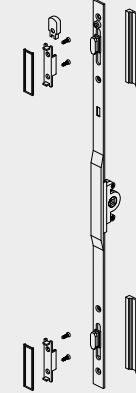

4188

Cierre multipunto
H = 1069-1868

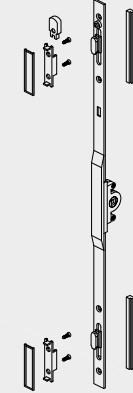

4189

Cierre multipunto
H> 1869

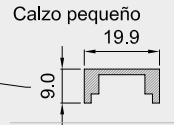

4190

Manilla
cuadrado 7 mm.

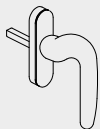

4858(D) / 4859(I)
Manilla corredera
acodada
cuadrado 7 mm.



4556

Escuadra Cerco/Hoja

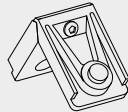

4038

Escuadra Cerco 3 Carriles



4116

Escuadra alineamie.
carriles



4109

Escuadra
Alineamiento hojas



4176

Valvula de
drenaje

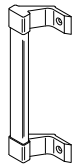

4153

Tirador grande



4118

Terminal acople
4 hojas

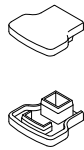

4339

Juego tapas
tirador postizo
(783-4)



4125

Tope hoja lateral



4855

Escuadra solapa 8893



4039

Escuadra inox.
alineamiento

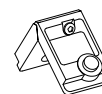

3627

Escuadra pulsante
para fijos

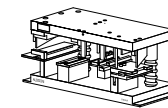

4555

Util multiple
Silver-60/70

Este folleto tiene un valor meramente informativo. El Grupo Alugom se reserva el derecho a realizar cualquier tipo de modificación, cambio de referencia, anular, eliminar definitiva o parcialmente, o quitar de stock cualquier perfil y/o accesorio que aparece en este documento, sin previo aviso.

